



## SSP SURFACE SCANNING PROBE SERIES FOR STANDARD OPTICAL PARTICLE COUNTERS

### 1. WHY SURFACE PARTICULATE DETECTION?

IN MANY INDUSTRIES THE MANUFACTURE OF AN ULTRACLEAN SURFACE IS CRUCIAL TO THE FUNCTIONALITY AND QUALITY OF THE PRODUCT. PARTICLES HAVE AN IMPACT ON THE OVERALL EFFECTIVENESS OF PROCESS EQUIPMENT, DECREASING TOOL AVAILABILITY AND INCREASING DEFECTS, REJECT RATES AND COSTS. THAT MAKES THE REDUCTION IF NOT AVOIDING OF PARTICLES ON SURFACES IS AN ESSENTIAL TASK OF AN EFFECTIVE QUALITY ASSURANCE. THE QUESTION IS HOW TO OBTAIN RELIABLE DATA GIVING EVIDENCE OF THE CLEANLINESS OF CRITICAL PARTS, WORK SURFACE, PROCESS EQUIPMENT, ETC.?

### 2. THE SOLUTION – SSP SURFACE SCAN PROBES HOOKING UP TO STANDARD APCS

WITH SSP SURFACE SCAN SYSTEMS THE USER CAN INSTANTLY ASSESS THE CLEANLINESS OF CRITICAL SURFACES SUCH AS SUPPLY CHAIN QA AND THE EFFECTIVENESS OF CLEANING PROCEDURES. ITS UNIQUE TECHNOLOGY AND PORTABLE DESIGN MAKES SSP SURFACE SCAN SYSTEMS THE PERFECT TOOL COMPANIES CONCERNED WITH SURFACE CLEANLINESS.



### 3. BENEFITS OF SSP SURFACE SCAN SYSTEMS

- INSPECTION OF CLEANLINESS BEFORE & AFTER CLEANING PROCESSES (WORK PIECES, TOOLS, EQUIPMENT, CLEANROOMS, ETC).
- QUALIFICATION OF PROCESSES
- CLEANLINESS QUALIFICATION OF INCOMING AND OUTGOING MATERIALS
- REDUCTION OF DOWN TIMES (E. G. MAINTENANCE CIRCLES)
- REDUCTION OF DEFECT AND REJECT RATES AND HENCE INCREASE OF PRODUCTIVITY

### 4. MAJOR PROS OF SSP SURFACE SCAN SYSTEMS

- ONLINE | DIRECT | RAPID
- MAKING THE STANDARD SOLAIR AIRBORNE OPC A DOUBLE USE SYSTEM <sup>1)</sup> AIRBORNE & SURFACE PARTICLE COUNTER
- AVAILABLE FOR MULTIPLE AIRFLOWS (1 CFM | 2 CFM | 100 LPM)
- NON DESTRUCTIVE
- ELIMINATING HUMAN ERROR SOURCES
- IONIZATION UNIT AS ACCESSORY AVAILABLE

<sup>1)</sup> EXCEPT BOULDER WHICH ONCE MODIFIED BECOMES A PURE SPC



## SSP SURFACE SCANNING PROBE SERIES FOR STANDARD OPTICAL PARTICLE COUNTERS

### 5. REQUIRED HARDWARE



$$\begin{array}{ccccc}
 \text{SSP} & + & \text{OPC} & = & \text{SPC} \\
 \text{SURFACE SCAN PROBE} & & \text{OPTICAL PARTICLE COUNTER} & & \text{SURFACE PARTICLE COUNTER} \\
 & & & & \text{(DOUBLE USE SYSTEM AIR \& SURFACE)}
 \end{array}$$

### 6. SSP – SURFACE SCAN PROBE FEATURES

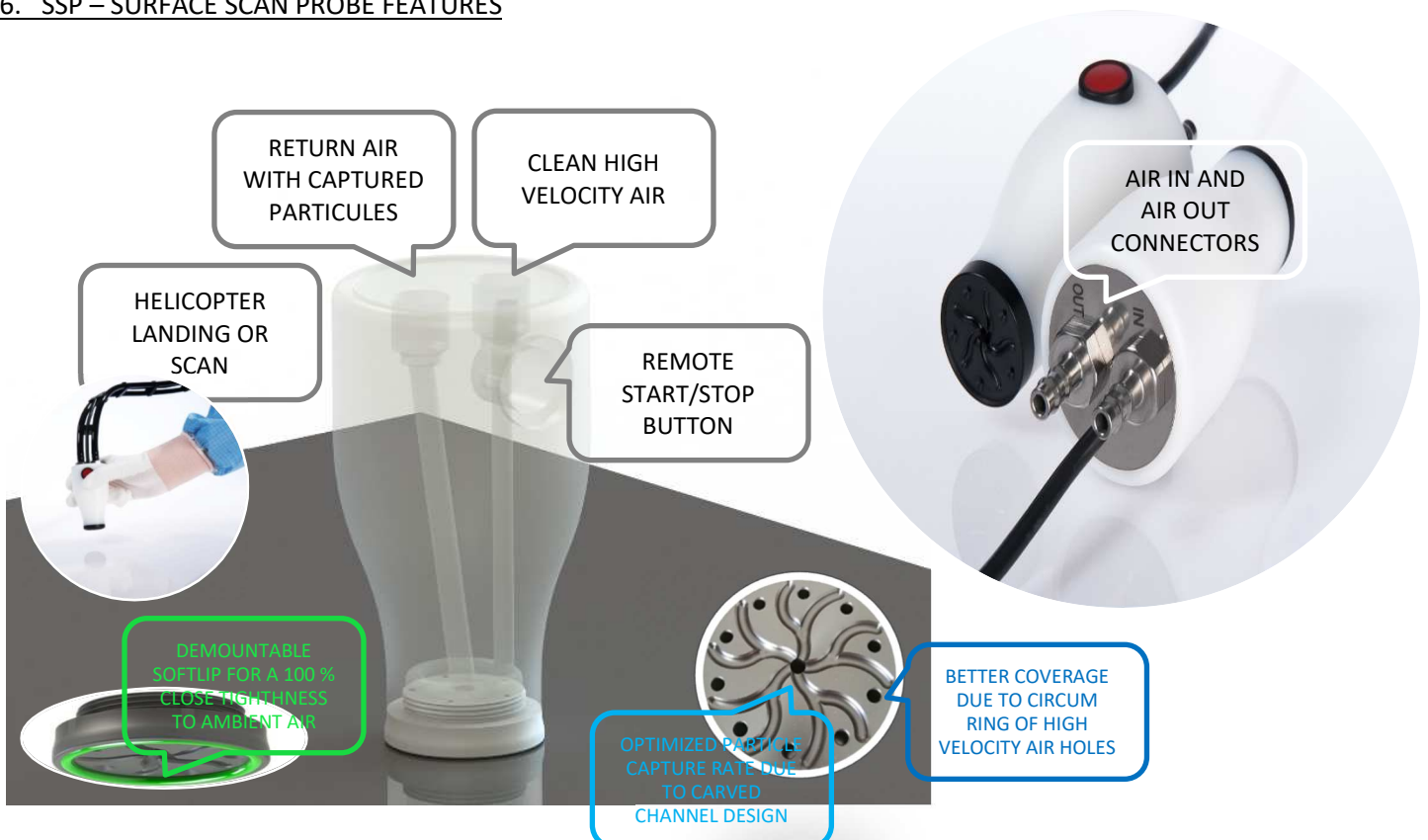



## SSP SURFACE SCANNING PROBE SERIES FOR STANDARD OPTICAL PARTICLE COUNTERS

### 7. SSP – SURFACE SCAN PROBE WORKING PRINCIPLE

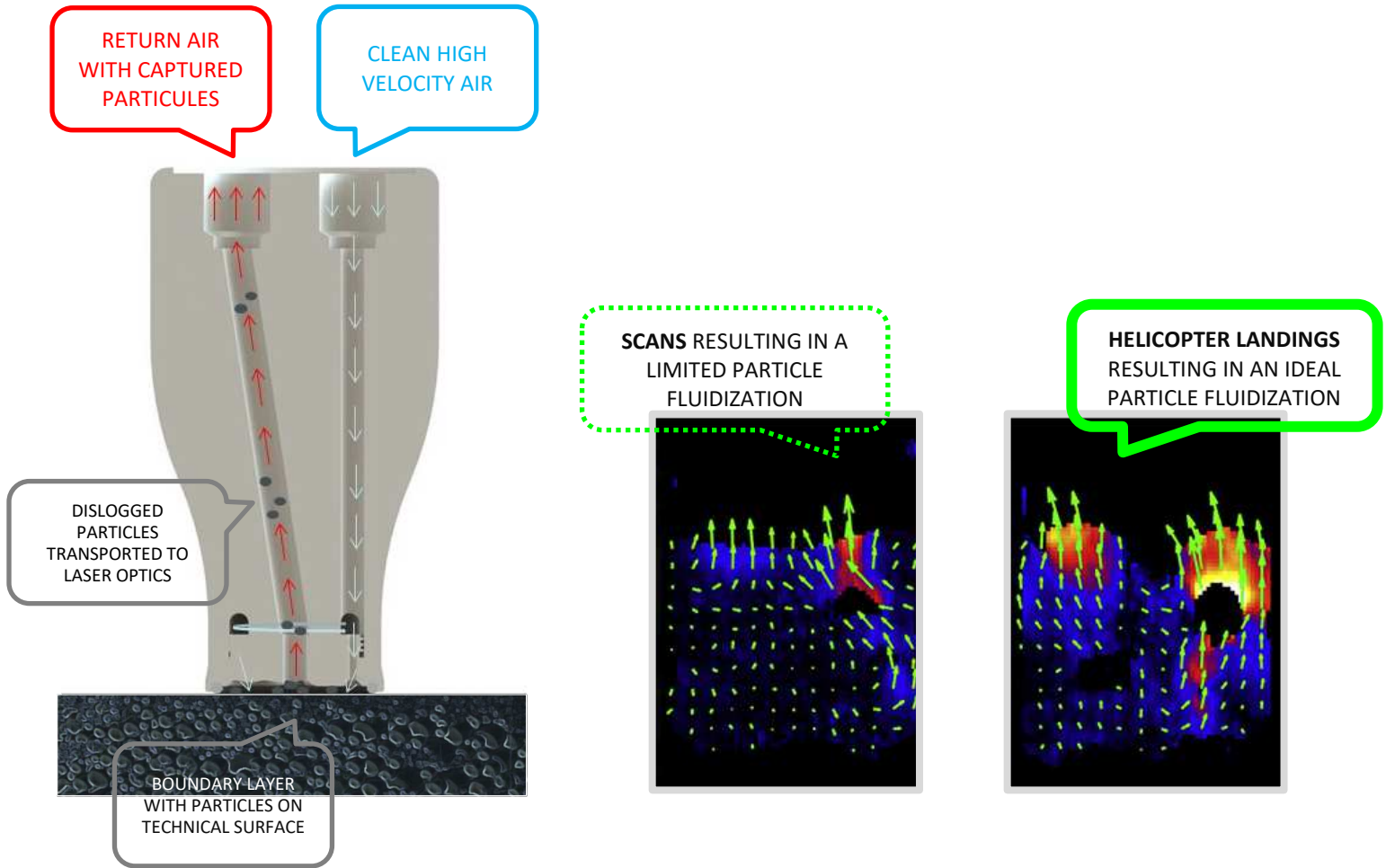



## SSP SURFACE SCANNING PROBE SERIES FOR STANDARD OPTICAL PARTICLE COUNTERS

### 8. AVAILABLE SSP VERSIONS

LINE	PICTURE	ITEM (MATERIAL)	CARRIER OPC	ITEM DESCRIPTION
010		SSP <b>100</b> SSP <b>50</b> SSP <b>30</b> SSP <b>1"</b> SSP <b>20</b> SSP <b>15</b> SSP <b>10</b>	  	SURFACE SCAN PROBE SSP <b>000</b> STANDARD HARDLIP FACEPLATE STRD. MAT. PROBE BODY: POM-C PROBE OD: 10 - 100 mm STANDARD SENSITIVITY: 0.3 $\mu\text{m}$ STANDARD FLOW RATE: 1 CFM ALT. FLOW RATE #1: 50 LPM ALT. FLOW RATE #2: 100 LPM START-/STOP MICRO SWITCH QUICK RELEASES FOR QUICK AND EASY TUBE EXCHANGE BEV-A-LINER TUBING PACKAGE
<b>ACCESSORIES (SPARE PARTS)</b>				
011		SOFTLIP <b>100</b> <b>POM-C / 316L /</b> <b>VESPEL / PEEK</b>		<b>100</b> mm SOFTLIP-RIM FACEPLATE (LATEX RUBBER) FOR A 100 % CLOSE TIGHTNESS TO AMBIENT AIR AND A BETTER NESTLING TO UNEVEN SURFACES
012		SOFTLIP <b>30</b> <b>POM-C / 316L /</b> <b>VESPEL / PEEK</b>		<b>30</b> mm SOFTLIP- RIM FACEPLATE (LATEX RUBBER) . . . AS ABOVE.
013		SOFTLIP <b>30</b> <b>POM-C / 316L /</b> <b>VESPEL / PEEK</b>		<b>30</b> mm SOFTLIP- RIM FACEPLATE (LATEX RUBBER) . . . AS ABOVE.
014		SOFTLIP <b>1"</b> <b>POM-C</b>		<b>1"</b> mm SOFTLIP- RIM FACEPLATE (LATEX RUBBER) . . . AS ABOVE.
015		SOFTLIP <b>20</b> <b>POM-C</b>		<b>20</b> mm SOFTLIP- RIM FACEPLATE (LATEX RUBBER) . . . AS ABOVE.
016		SOFTLIP <b>15</b> <b>POM-C</b>		<b>15</b> mm SOFTLIP-RIM FACEPLATE (LATEX RUBBER) . . . AS ABOVE.
017		SOFTLIP <b>10</b> <b>POM-C</b>		<b>10</b> mm SOFTLIP-RIM FACEPLATE (LATEX RUBBER) . . . AS ABOVE.
018	ZC.PROTECT.CAP	ZC.CAP		ZERO COUNT & IMPACT PROTECTION CAP
019	TSI.ADA.KIT	TSI.ADA.KIT		TSI AEROTRAK ADAPTER KIT INCL. REAR SIDE ADAPTER AND ADAPTER CABLE
020	0.1 $\mu\text{m}$	0.1		IMPROVED SENSITIVITY DOWN TO 0.1 $\mu\text{m}$



## SSP SURFACE SCANNING PROBE SERIES FOR STANDARD OPTICAL PARTICLE COUNTERS

LINE	PICTURE	ITEM (MATERIAL)	CARRIER OPC	ITEM DESCRIPTION
030		SSP MINI <b>20</b> SSP MINI <b>15</b> SSP MINI <b>8.6</b>		SURFACE SCAN PROBE SSP <b>MINI</b> STANDARD HARDLIP FACEPLATE STRD. MAT. PROBE BODY: POM-C PROBE OD: 8,6 - 20 mm SANDARD SENSITIVITY: 0.3 µm STANDARD FLOW RATE: 1 CFM ALT. FLOW RATE #1: 50 LPM ALT. FLOW RATE #2: 100 LPM EXTERNAL CABLE WITH START-/STOP MICRO SWITCH QUICK RELEASES FOR QUICK AND EASY TUBE EXCHANGE BEV-A-LINER TUBING PACKAGE
<b>ACCESSORIES (SPARE PARTS)</b>				
031		SOFTLIP <b>20</b> <b>POM-C</b>		<b>20</b> mm SOFTLIP- RIM FACEPLATE (LATEX RUBBER) . . . AS ABOVE.
032		SOFTLIP <b>15</b> <b>POM-C</b>		<b>15</b> mm SOFTLIP-RIM FACEPLATE (LATEX RUBBER) . . . AS ABOVE.
033		SOFTLIP <b>8.6</b> <b>POM-C</b>		<b>8.6</b> mm SOFTLIP-RIM FACEPLATE (LATEX RUBBER) . . . AS ABOVE.
034		HEMI <b>50</b> <b>POM-C / 316L</b>		<b>Ø 50</b> MM FACEPLATE <b>HEMISPHERIC</b> <b>FOR MEASURING VOLUMETRIC COMPONENTS</b>
035	ZC.PROTECT.CAP	ZC.CAP		ZERO COUNT & IMPACT PROTECTION CAP
036	TSI.ADA.KIT	TSI.ADA.KIT		TSI AEROTRAK ADAPTER KIT INCL. REAR SIDE ADAPTER AND ADAPTER CABLE
037	0.1 µm	0.1		IMPROVED SENSITIVITY DOWN TO 0.1 µm



## SSP SURFACE SCANNING PROBE SERIES FOR STANDARD OPTICAL PARTICLE COUNTERS

LINE	PICTURE	ITEM (MATERIAL)	CARRIER OPC	ITEM DESCRIPTION
040		SSP TUBE <b>10</b> <b>316L</b>	  	SURFACE SCAN PROBE SSP <b>TUBE</b> STANDARD HARDLIP FACEPLATE STRD. MAT. PROBE BODY: POM-C AND TUBE IN STAINLESS STEEL <b>FOR MEASSURING IN NARROW SPACES            AND TUBES</b> PROBE OD: 10 mm SANDARD SENSITIVITY: 0.3 µm STANDARD FLOW RATE: 1 CFM ALT. FLOW RATE #1: 50 LPM EXTERNAL CABLE WITH START-/STOP MICRO SWITCH QUICK RELEASES FOR QUICK AND EASY TUBE EXCHANGE BEV-A-LINER TUBING PACKAGE
<b>ACCESSORIES (SPARE PARTS)</b>				
041	ZC.PROTECT.CAP	ZC.CAP		ZERO COUNT & IMPACT PROTECTION CAP
042	TSI.ADA.KIT	TSI.ADA.KIT		TSI AEROTRAK ADAPTER KIT INCL. REAR SIDE ADAPTER AND ADAPTER CABLE
043	0.1 µm	0.1		IMPROVED SENSITIVITY DOWN TO 0.1 µm



## SSP SURFACE SCANNING PROBE SERIES FOR STANDARD OPTICAL PARTICLE COUNTERS

LINE	PICTURE	ITEM (MATERIAL)	CARRIER OPC	ITEM DESCRIPTION
050	   	NOVA <sup>°</sup> 00  NOVA 90°		SURFACE SCAN PROBE <b>NOVA</b> COMING W/HARDLIP FACEPLATE MATERIAL: ALUMINUM (BODY) / POM-C (FACEPLATE / STAINLESS STEEL (TUBING PAIR) PROBE OD: 30 & 50 MM STANDARD SENSITIVITY: 0.3 µm STANDARD FLOW RATE: 1 CFM ALT. FLOW RATE #1: 50 LPM ALT. FLOW RATE #2: 100 LPM START-/STOP MICRO SWITCH QUICK RELEASES FOR QUICK AND EASY TUBE EXCHANGE BEV-A-LINER TUBING PACKAGE
<b>ACCESSORIES (SPARE PARTS)</b>				
051	TUBE LENGTH 	TL <b>350</b> TL <b>500</b> TL <b>750</b> TL <b>1000</b>		350 mm VERSION SURCHARGE FOR <b>500</b> mm VERSION SURCHARGE FOR <b>750</b> mm VERSION SURCHARGE FOR <b>1000</b> mm VERSION
052		SOFTLIP <b>50</b> POM-C		<b>50</b> mm SOFTLIP- RIM FACEPLATE (LATEX RUBBER) . . . AS ABOVE.
053		SOFTLIP <b>30</b> POM-C		<b>30</b> mm SOFTLIP- RIM FACEPLATE (LATEX RUBBER) . . . AS ABOVE.
054	ZC.PROTECT.CAP	ZC.CAP		ZERO COUNT & IMPACT PROTECTION CAP
055	TSI.ADA.KIT 	TSI.ADA.KIT		TSI AEROTRAK ADAPTER KIT INCL. REAR SIDE ADAPTER AND ADAPTER CABLE
056	0.1 µm	0.1		IMPROVED SENSITIVITY DOWN TO 0.1 µm



## SSP SURFACE SCANNING PROBE SERIES FOR STANDARD OPTICAL PARTICLE COUNTERS

LINE	PICTURE	ITEM (MATERIAL)	CARRIER OPC	ITEM DESCRIPTION
060		SSP <b>ROK-1</b>	 	SURFACE SCAN PROBE <b>ROK-1</b> SOFLIP FACEPLATE MATERIAL: STAINLESS STEEL + ABS SSP DIMENSIONS: <b>32 x 21 mm</b> STANDARD SENSITIVITY: 0.3 $\mu\text{m}$ STANDARD FLOW RATE: 1 CFM ALT. FLOW RATE #1: 50 LPM ALT. FLOW RATE #2: 100 LPM START-/STOP MICRO SWITCH QUICK RELEASES FOR QUICK AND EASY TUBE EXCHANGE BEV-A-LINER TUBING PACKAGE
<b>ACCESSORIES (SPARE PARTS)</b>				
061	TSI.ADA.KIT	TSI.ADA.KIT		TSI AEROTRAK ADAPTER KIT INCL. REAR SIDE ADAPTER AND ADAPTER CABLE
062	0.1 $\mu\text{m}$	0.1		IMPROVED SENSITIVITY DOWN TO 0.1 $\mu\text{m}$





## SSP SURFACE SCANNING PROBE SERIES FOR STANDARD OPTICAL PARTICLE COUNTERS

LINE	PICTURE	ITEM (MATERIAL)	CARRIER OPC	ITEM DESCRIPTION
070		SSP <b>BOULDER</b>		<p>SURF. SCAN PROBE <b>BOULDER</b> FOR LIGHTHOUSE BOULDER OPC (ILD = INTEGRATED LASER DIODE)</p> <p>STANDARD SENSITIVITY: 5 <math>\mu</math>m STANDARD FLOW RATE: 1 CFM START-/STOP MICRO SWITCH QUICK RELEASES FOR QUICK AND EASY TUBE EXCHANGE BEV-A-LINER TUBING PACKAGE</p>
<b>ACCESSORIES (SPARE PARTS)</b>				
011		SOFTLIP <b>100</b> <b>POM-C</b>		<b>100</b> mm SOFTLIP-RIM FACEPLATE (LATEX RUBBER) FOR A 100 % CLOSE TIGHTNESS TO AMBIENT AIR AND A BETTER NESTLING TO UNEVEN SURFACES
071		SOFTLIP <b>50</b> <b>POM-C</b>		<b>50</b> mm SOFTLIP- RIM FACEPLATE (LATEX RUBBER) . . . AS ABOVE.
072		SOFTLIP <b>30</b> <b>POM-C</b>		<b>30</b> mm SOFTLIP- RIM FACEPLATE (LATEX RUBBER) . . . AS ABOVE.
073	ZC.PROTECT.CAP	ZC.CAP		ZERO COUNT & IMPACT PROTECTION CAP